



ADINA APARTMENT HOTEL SYDNEY AIRPORT

ADINA APARTMENT HOTEL SYDNEY AIRPORT

CHALLENGE

- Developer owned an existing office tower and had sub divided the land and sold the tower - presented a hotel development that proved to be not financially optimised primarily due to the cost to develop the car park. The building shape and carpark layout were different, with a splayed building over a rectangular carpark, which would have increased the building cost substantially
- A number of significant trees on the site were required to be removed, which the Council objected to

SOLUTIONS PRESENTED BY TFE HOTELS

- Building layout revised and made more efficient by aligning of the structure with basement below to minimise the transfer structure
- One accommodation wing realigned to avoid destruction of existing significant trees
- Car park excavation costs and cost to remove contaminated materials significantly reduced due to reduction in basement height and area

OUTCOME

- Lowered construction cost with same number of keys built compared to original design
- Retained 40 car spaces within smaller basement footprint
- Saved 6 large fig trees on site
- Creation of a financially viable hotel project

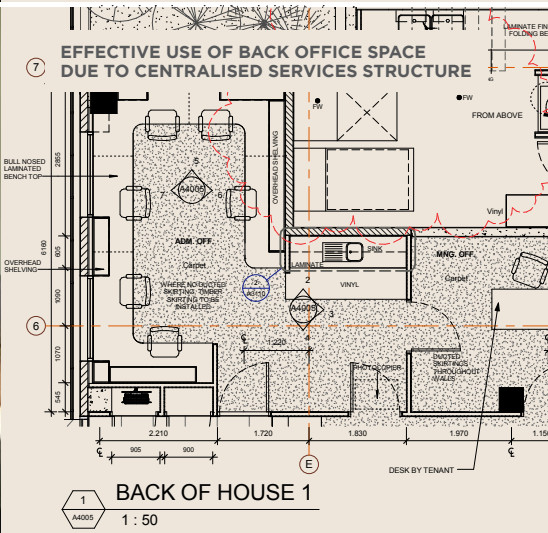

development.TFEhotels.com